

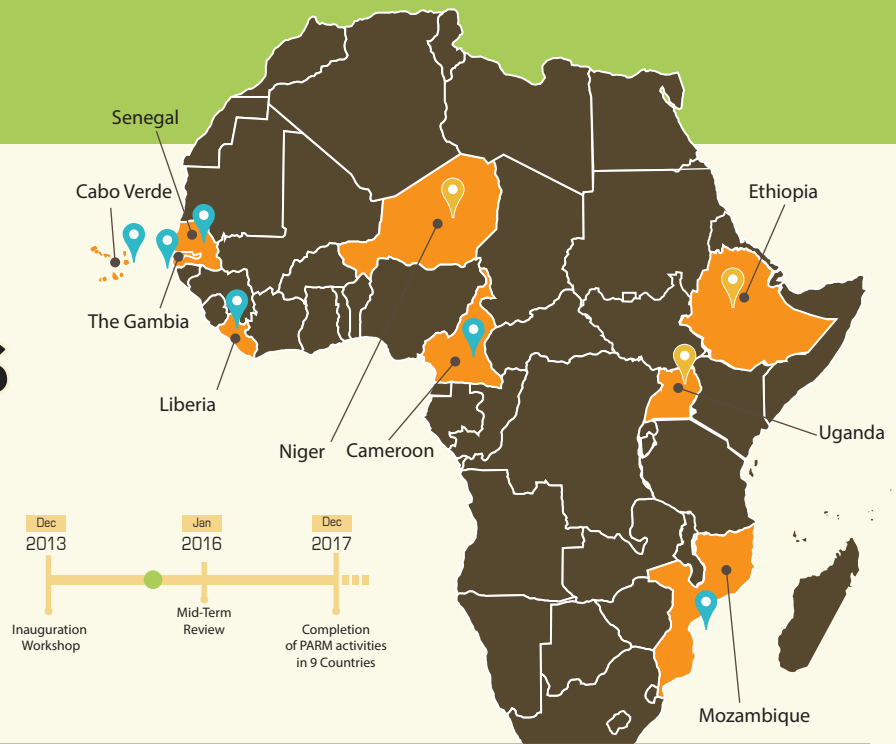

Where Are We? Our Results

May 2015

The Platform for Agricultural Risk Management (PARM), an outcome of the G8 and G20 discussions on food security and agricultural growth, is a four year multi-donor partnership between developing nations and development partners to make risk management an integral part of policy planning and implementation in the agricultural sector.



Setting-up Phase
 Risk Assessment Phase
 Policy Dialogue Phase
 Follow-up/M&E Phase
 Implementation Phase

Since its inception in December 2013, PARM has worked for a better management of risks in agriculture in developing countries, considered as a main constraint to improve farmers' livelihoods. PARM's governance has been designed to build partnerships and knowledge networks on Agricultural Risk Management (ARM), mobilizing existing resources and expertise. PARM is promoting a holistic preparedness approach to empower farmers and stakeholders with ARM tools and strategies, rather than resigning to cope with disasters. This is the essence of the Platform as a neutral environment where ARM demands and needs are rigorously identified and assessed, and where experts and service providers can develop tailored tools to these demands. During its first year of existence, PARM has consolidated its partnerships and launched setting up activities in six African countries. PARM efforts have been concentrated so far on developing a business model for the elaboration of studies, capacity development, and on implementing an ambitious knowledge management strategy.

GOVERNANCE KEY ACTIVITIES

- PARM-NEPAD partnership
February 2014
- Launch of PARM and establishment of the Secretariat
September 2015
- Engagement with the Steering Committee and establishment of the Advisory Committee
December 2013
April /October 2014
March 2015

NEPAD has been identified as PARM strategic partner and one of the main implementing entities in Africa. On February 2014 an Implementation Agreement was signed between IFAD and NEPAD to facilitate PARM process in bringing ARM tools into the agricultural investment plans, within the Comprehensive Africa Agriculture Development Programme (CAADP) framework.

The Platform was officially launched during "IFAD-NEPAD Inauguration Workshop of the PARM" from 3-4 December 2013 in IFAD Headquarters in Rome. PARM activities have been carried out by an interim secretariat until the appointment of the official PARM Secretariat in early September 2014.

PARM network is already operational through the activities of the two PARM governance committees, created in 2014. The Steering Committee brings together the donor agencies and strategic partners (EC, AFD, Italy, IFAD and NEPAD) and it has already met four times. The Advisory Committee brings together a broader set of stakeholders and is engaged on more technical and methodological discussions.

KNOWLEDGE MANAGEMENT KEY ACTIVITIES

- KM/Communication strategy, launch of PARM website and products
- Warehouse Receipt Study (by AFD, CTA, IFAD on 9 African Countries)
- Capacity building
- Engagement in ARM events and enhancing synergies

A KM/Communication strategy has been presented during the 4th Steering Committee in March 2015 and it is now under implementation. The strategy is closely aligned with the programme overall objectives and strictly integrated within the PARM process, capacity development (CD) and monitoring and evaluation activities. In 2014, the strategy has focused on creating raise PARM visibility, undertaking studies and assessing the needs of the stakeholders in order to develop tailored KM products for the different target audiences.

To reinforce the working dynamics of the platform, PARM has been active in several meetings and initiatives by different agencies and stakeholders, including FARM-D, AFRACA, Agrinatura, FAO and NEPAD.

OUR DONOR PARTNERS



OUR STRATEGIC PARTNER



OUR ADVISORY PARTNERS





COUNTRY ACTIVITIES

PARM-NEPAD partnership, in cooperation with other agencies such as the FAO and World Bank has already initiated ARM assessments and policy processes in Ethiopia, Niger and Uganda, and is beginning to operate in Cameroon, Senegal, The Gambia and Cabo Verde.

Risk Assessment

Niger



WHERE ARE WE?

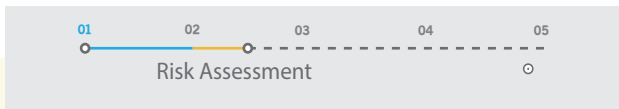

01 Setting-up



PAGRA Validation Workshop

June 2014

A National Stakeholder workshop, led by the World Bank with active participation of PARM (Interim Secretariat) and NEPAD, was held in Niamey from 10 to 11 June 2014 to contribute to the improvement of the Plan d'Action pour la Gestion des Risques Agricoles (PAGRA), identifying priorities and develop a country road map.



Setting-up Mission

December 2014

The newly appointed PARM Secretariat jointly with NEPAD organised its first joint mission to Niger from 9-12 December 2014 to follow-up on the PAGRA Validation Workshop, to build synergies and re-launch activities in the country.

Three main areas have been identified (micro finance, credit and market access of smallholders) to be covered by PARM Risk Assessment Study to complete the 2014 World Bank analysis on ARM. Potential partners to support PARM studies and capacity development have been identified.



Road map developed

January 2015

PARM Road map was developed and validated by the Haut Commissariat à l'Initiative 3N (HC3N).



Risk Assessment Terms of Reference

February 2015

The Terms of Reference for the Risk Assessment has been developed and validated by HC3N.

02 Risk Assessment



Risk Assessment Study Kick-off

May 2015

The Institut de Recherches et d'Applications des Méthodes de développement (IRAM) has been identified and recruited to undertake the Risk Assessment study in Niger in collaboration with local experts which is expected to start end of May 2015 and finalized by September 2015.



TO BE CONTINUED...

Risk Assessment

Uganda



WHERE ARE WE?

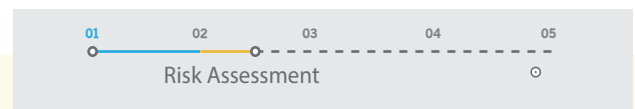

01 Setting-up



Setting-up Mission

December 2014

The PARM Team organised its first visit (jointly with NEPAD) to the country from 15-18 December 2014 to follow-up on the ARM process already started with FAO and NEPAD in 2013, with the establishment of a National Steering Committee (NSC). The mission served to re-launch the NSC and PARM activities in the country. The need of an additional study on ARM Information System (ARM-IS) was identified by the Government to complement the Risk Assessment study undertaken by PARM. Potential partners to support PARM studies and capacity development plan were also identified.



Road map developed

December 2015

PARM Road map was developed and validated by the NSC and the Government.



Risk Assessment Terms of Reference

February 2015

The Terms of Reference (TORs) for the Risk Assessment has been developed and validated by the National Agricultural Risk Management (ARM) Steering Committee (NSC) and the CAADP focal point.

02 Risk Assessment



Risk Assessment Study Kick-off

March 2015

A pool of experts both international and local (from Makerere University) has been identified and recruited to undertake the Risk Assessment study in Uganda which started on March and is expected to be completed by June 2015.



Information System Study Kick-off

May 2015

The Terms of Reference for the Agricultural Risk Management Information Study have been developed in collaboration with NEPAD and the Uganda CAADP Focal point. A local expert has been identified to undertake the study which has started in early May and it is expected to be completed by June 2015.



TO BE CONTINUED...

Risk Assessment

Ethiopia



WHERE ARE WE?

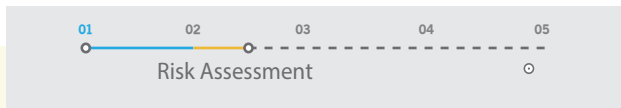

01 Setting-up



Kick-off Workshop November 2014

PARM activities kicked-off in Ethiopia in occasion of the “Policy Forum on Integrating agriculture and food risk management and innovative financial services” jointly organized by AFRACA, NEPAD, PARM and FAO in Addis Ababa on 11-13 November 2014. It resulted in a formal commitment to support the establishment of a National Steering Committee on ARM. The State MoA will ensure the leadership of the process, assisted by the ATA and a pool of facilitators as: AEMFI, IFAD, NEPAD, FAO and PARM Secretariat.



Setting-up Mission February 2015

A setting-up mission was undertaken from 9 to 12 February 2015. During the mission, a PARM Road Map and was developed and discussed with the temporary ad hoc National Steering Committee. Potential partners to support PARM studies and capacity development plan were also identified



Risk Assessment Terms of Reference February 2015

The Terms or Reference (TORs) for the Risk Assessment has been developed and discussed with temporary ad hoc National Agricultural Risk Management (ARM) Steering Committee (NSC).

02 Risk Assessment



Risk Assessment Study Kick-off May 2015

The Natural Resources Institute (NRI) from the University of Greenwich (member of Agrinatura network) has been identified to undertake the Risk Assessment study in Ethiopia in collaboration with local experts which is expected to be completed by September 2015.



TO BE CONTINUED...

Setting-up

Senegal



WHERE ARE WE?

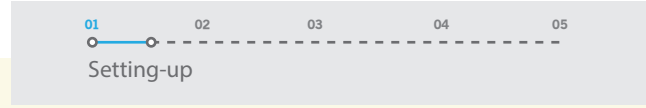

01 Setting-up



World Bank ARM Workshop March 2015

PARM participated in the World Bank “Risk Assessment and Response in the agricultural sector” workshop held on 12 March 2015 to explore synergies with the on-going ARM initiatives and present PARM in view of the setting-up mission.



Setting-up Mission April 2015

A joint PARM-NEPAD first country visit in Senegal was undertaken from 13 to 19 April 2015. The mission represented the first step of PARM process in Senegal and to find complementarities with the Risk Assessment Study (RAS) recently undertaken by the World Bank. The main achievement of the mission has been the informal commitment expressed by the MoA, through the SG, to insert PARM in the national agenda. A multi-sector pool of experts coming from different Ministries and organizations has been constituted to identify the gaps of the current RAS and to be integrated (partially or totally) by PARM process. A formal comittment from the Government is expected by May-June 2015.



Road Map Development May 2015

A road map is being developed by the Government in collaboration with the CAADP Focal Point and is expected to be completed by end of May 2015.



TO BE CONTINUED...

Setting-up

The Gambia



WHERE ARE WE?



01 Setting-up



Meeting with the Minister of Agriculture December 2014

A first meeting between the PARM Secretariat and the Minister of Agriculture of the Gambia took place in IFAD HQ, Rome in December 2014 to follow-up on the government request to integrate the country into the PARM process.



Setting-up Mission April 2015

The PARM Team organised its first visit (jointly with NEPAD) to the country from 20 to 24 April 2015 to present PARM and getting the official engagement and funds commitment from the Government. Potential synergies to support PARM studies and capacity development plan were also identified.



Official engagement and Road Map May 2015

An official letter of engagement from Government of Gambia is expected by end of May 2015, including the nomination of PARM focal point in charge to develop the road map



TO BE CONTINUED...

Setting-up

Cameroon



WHERE ARE WE?



01 Setting-up



Meeting with the Vice-Minister of Agriculture February 2015

A meeting with the Cameroon delegation headed by the Ministry of Agriculture (MINADER) was held in IFAD HQ in Rome, with the objective to present PARM process and its complementarities with an on-going study funded by the AFD on ARM in value chains.



Setting-up Mission April 2015

The PARM Team organised its first visit (jointly with IFAD) to the country from 5 to 14 March 2015 to get the official commitment of the Government of Cameroon and to develop a road map. Potential synergies to support PARM studies and capacity development plan were also identified.



Official Engagement and Road Map May 2015

An official commitment letter was addressed to the President of IFAD in March 2015 and a CAADP focal point has been nominated to support PARM process. A draft road map is being developed and it is expected to be finalized by May/June 2015.



TO BE CONTINUED...

Setting-Up

Mozambique



First Country Contacts November 2014

PARM has started its first country contacts with the Ministry of Agriculture during the FARM-D forum organized by the World Bank in South Africa. Considering the elections in October 2014 the country is still listed as a 2015 target of PARM and a first country visit is planned for the second quarter 2015.

Setting-Up

Cabo Verde



NEPAD Country Visit April 2015

A NEPAD first country visit in Cape Verde took place in April 2015 to launch the PARM setting-up phase and engage in the first contacts with the government and national stakeholders.

Setting-Up

Liberia



Activities will start in 2016.

Coming Up

NIGER

Risk Assessment Workshop
September 2015 (tbc)

Policy Dialogue Workshop
December 2015 (tbc)

UGANDA

Risk Assessment Workshop
29-30 June 2015

Capacity Building Training
2-3 June 2013

Policy Dialogue Workshop
November 2015 (tbc)

ETHIOPIA

Risk Assessment Workshop
September 2015 (tbc)

Policy Dialogue Workshop
November 2015 (tbc)

STEERING COMMITTEE

Mid-year Review Meeting
8 July 2015, Teleconference

Planning Review Meeting
November 2015, Johannesburg

Contacts

PARM Secretariat

International Fund for Agricultural
Development
Via Paolo di Dono, 44 - 00142 Rome, Italy

✉ parm@ifad.org
📱 @PARMinfo

www.p4arm.org